

# IoT Node PLC IP65

With multifunctional outdoor luminaire controller CitySys IoT Node streetlight luminaires gain personality. Great compatibility and easy installation into luminaires or poles from different manufacturers make it the perfect choice for remote luminaire control.

Key features

- Great compatibility and easy installation into luminaires or poles from different manufacturers makes the CitySys IoT Node a perfect choice for remote luminaire control.
- Dimming profile upload and energy measurement download from luminaire is enabled through continuous real time communication over power line or wireless networks.
- Built-in control interface DALI and RELAY enables CitySys IoT Node to save energy by adjusting luminaire dimming level according to the dimming profile.
- CitySys IoT Node can detect luminaire failures through precise energy measurement with its built-in energy meter.
- Street lights can become even smarter by combining sensor technologies like movement sensors or traffic sensors with CitySys IoT Node outdoor luminaire controller.

Communication	
PLC	HD-PLC technology
	Dynamic mesh topology
	Network size up to 128 nodes
	Network depth up to 10 hops
Power	
Voltage	90 - 240 VAC
Frequency	50/60 Hz
Peak over voltage	600V
Input current	30mA for 230VAC
Power consumption	<2W (Max peak 4W)
Power input:	H07RN-F 2x1.5mm² 0.5m
Power output and DALI:	H07RN-F 4x1.5mm² 0.5m
Max. output power (relay)	
Wiring	AWG 26 - 14 (0.14 - 2.5 mm2)
Inputs and Outputs	
Mains power	1x
Relay output	1x
DALI interface with power	1x (max. 30 mA)



Size and Weight	
Width	130 mm
Depth	90 mm
Height	60 mm
Weight	300 g
Enclosure	
IP class	65
Environmental requirements	
Operating temperature	from -40° to +55° C (Higher ambient temperature allowed as long as Tcase max is not exceeded)
T case max	75 °C
Storage temperature	from -40° to 85° C
Relative humidity	< 95%, non-condensing

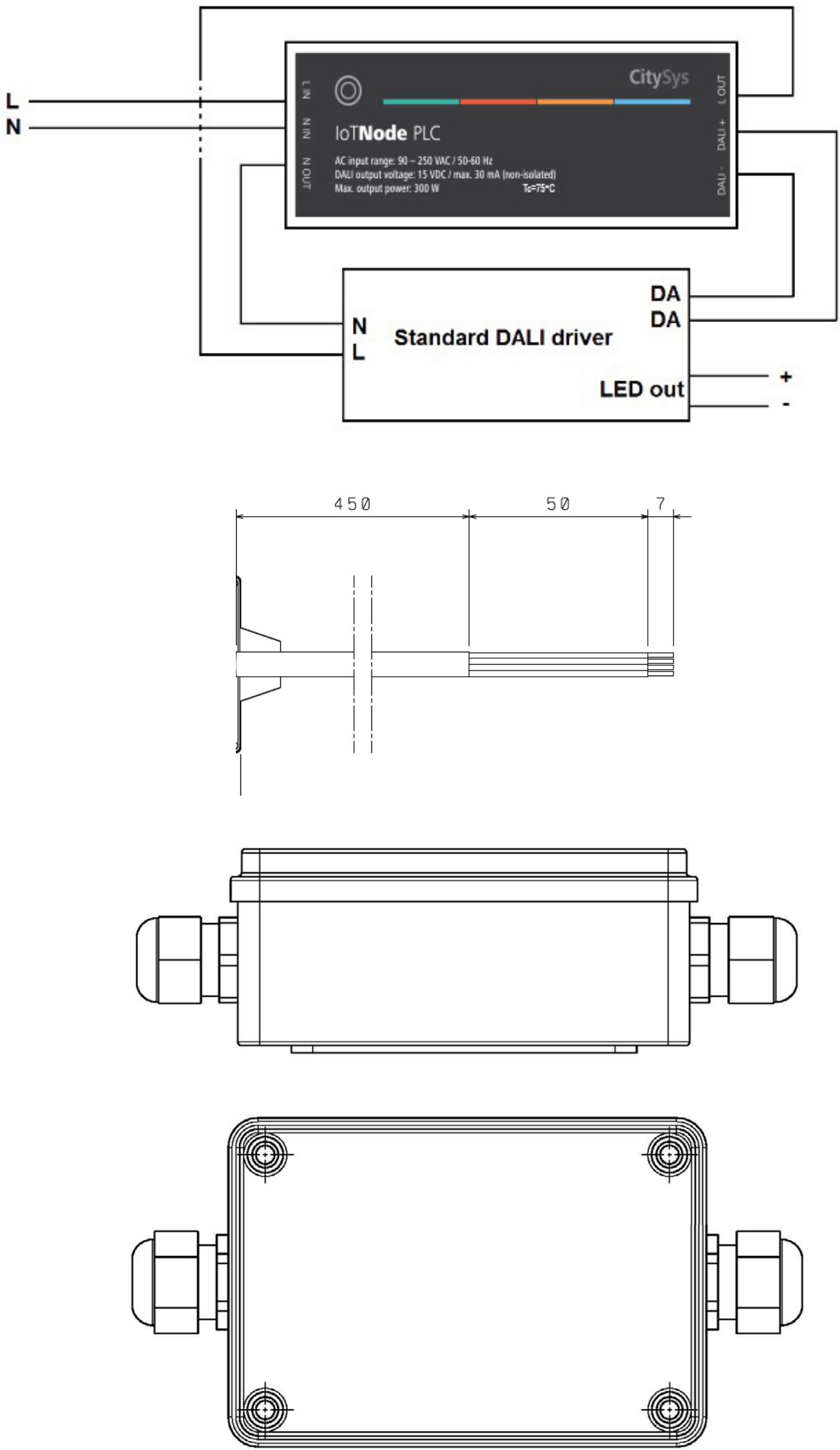

\* The Company reserves the right to change any product specifications without prior notification.