

Submerged | 9 x powerLEDs 14 W 24 V | CRI 80
97643N60

Single emission submerged for outdoor application. The natural white LED light source with a flood light distribution is composed of 9 powered LEDs with CCT of 4000 K and a CRI 80; the source luminous flux is 1710 lm, with a 122.1 lm/W nominal luminous efficacy.

The device body is made of stainless steel and features a steel finish, processed by means of brushing. The ingress protection degree is IP68; the total weight is of 2.816 kg. The power supply driver is not provided and is to be ordered separately.

The total absorbed power is 14 W. The power supply cable is included and features.

The device features protection class III and can be wall lights or floor-mounted with an outer casing, code 84943(for concrete or masonry).

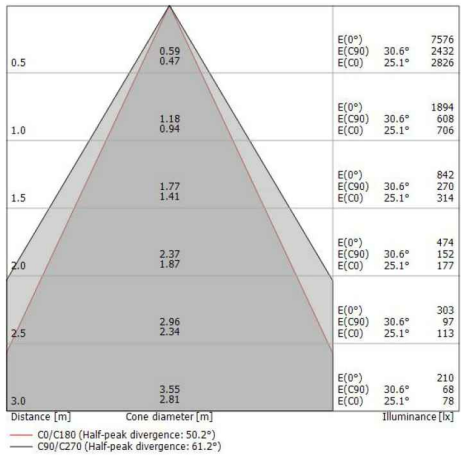
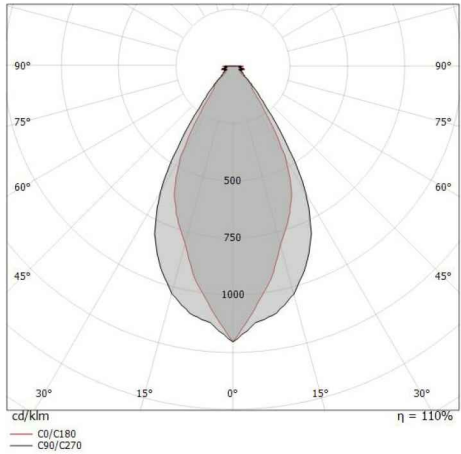

Illuminotechnical Features	
Light Output Ratio (LOR)	91 %
Luminous flux (source)	1710 lm
Luminaire luminous flux	1573 lm
Consumption	14 W
Luminaire efficacy	112 lm/W
Colour temperature	4000 K
Colour rendering index	80 Ra
Life / Failure Ratio	
L70 B10 C0 361980h (at Tj 60 °C Ta 25 °C)	

UGR	
X=4H Y=8H	S=0.25H
Reflection factor	70/50/20
UGR transversal	< 28
UGR axial	< 28

OPTICAL	
Light distribution simmetry	Asymmetrical
C0/C180 optics	50°
C90/C270 optics	61°

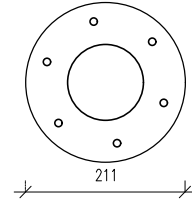
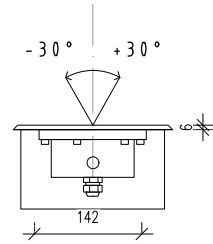

svietidlo nerezová oceľ
linealight.com
-Admiral_ JI- alebo ekvivalent
ø =211

Submerged | 9 x powerLEDs 14 W 24 V | CRI 80
97643N60



SVIETIDLO



Outer casing
Type of installation: pavimento/muratura
L=105mm, H=190mm, D=190mm

CHRÁN I ČKA

Technical data	
Type	Frame
Installation position	Wall lights - Floor
Installation environment	Outdoor
Light Source	LED
Optics	Flood
Power	14 W
Luminous flux (source)	1710 lm
Voltage	24V
CCT / Tone	4000 K
Colour rendering index	80 Ra
C.C. / C.V.	CV
Energy class	A+
Safety class	3
IP	IP68
IK	IK10
Glow wire test	850°
Direct mounting on normally flammable surfaces	Yes
CE	Yes
ETL	No
Fire Rated (BS 476 PT21 compliant)	No
Operating temperature	-20°C / +50°C
Driver included	No
Induction	No
Emergency mode	No
Directional	No
Tilting	Yes
total angle (horizontal plane)	360 °
total angle (vertical plane)	20 °
Walk-over	Yes
Drive-over	No
Cable included	Yes
Cable length	5 m
Resin potting	Yes
Type of light emission	Single emission
Net weight	2.816 Kg

Finishing casing	
Material	Stainless steel 316
Colour	steel
Processing	Brushing

Electronics	
89179	On/Off Driver 190~250V AC / 180~275V DC 24 W
89359	On/Off Driver 90~264V AC / 127~370V DC 48 W
99332	1-10V Multi Power 190~250V AC 150 W
99331	On/Off Driver 190~250V AC 150 W

Mierka:

1:- -

Označenie výkresu:

SO 01.01 - 05 - 20

Názov výkresu:

ŠPECIFIKÁCIA SVIETIDLA V SCHODISKOVOM STUPNI